

直交軸系列 齒輪減速機

Right-Angle Gear Reducer

5 GN - 150 RH



應用範例 Examples

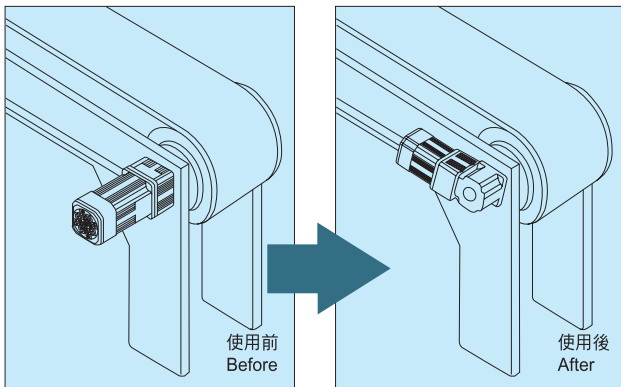

使用差異 Difference in usage

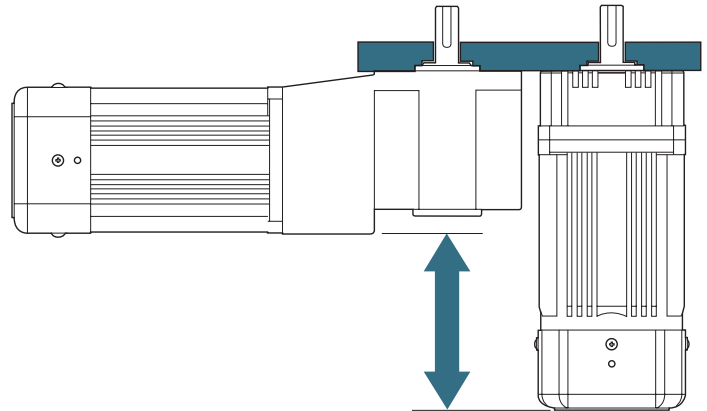

轉矩表 Torque Table (Kg·cm)

(Kg · cm) x 9.8/100=N·m

減速比	10	15	20	25	30	40	45	50	60	75	90	100	120	150	180	200	250	300	350	400	500	600	
25W	9.3	14	19	23	28	37	42	47	58	72	87	96	120	120	120	120	120	120	120	120	120	120	120
40W	13.4	20	27	34	40	54	61	67	83	104	125	140	140	140	140	140	140	140	140	140	140	140	140
60W	19.6	29	39	49	59	79	88	98	122	152	183	203	244	260	260	260	260	260	260	260	260	260	260
90W	29.5	44	59	74	88	118	133	147	183	229	260	260	260	260	260	260	260	260	260	260	260	260	260
120W	36.7	55	73	92	110	147	165	184	228	260	260	260	260	260	260	260	260	260	260	260	260	260	260
150W	48.9	73	98	122	147	196	220	245	260	260	260	260	260	260	260	260	260	260	260	260	260	260	260
效率	51.75%					53.50%					61.38%												

以上數值若有變動，恕不另行通知 We reserve the right to change without further notice.

■ 尺寸圖 Dimension Chart

4GN

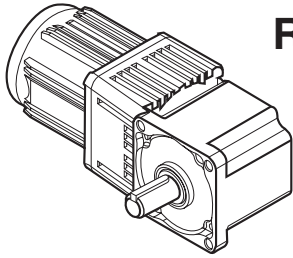

RA

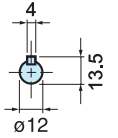
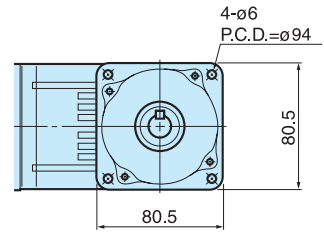
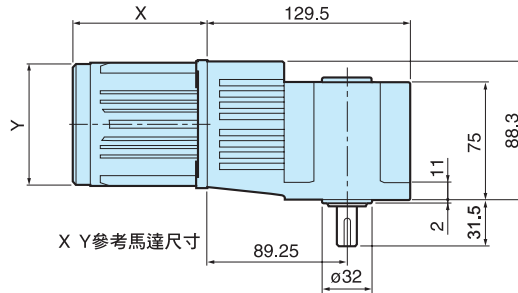

X Y 參考馬達尺寸

RH

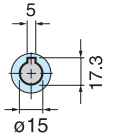
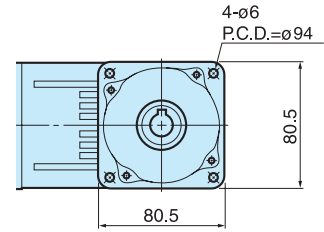
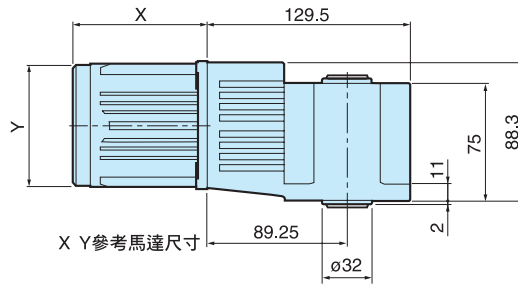
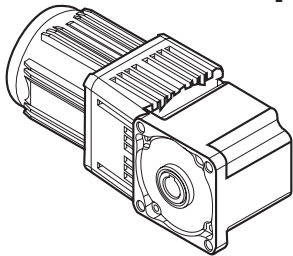

X Y 參考馬達尺寸

5GN

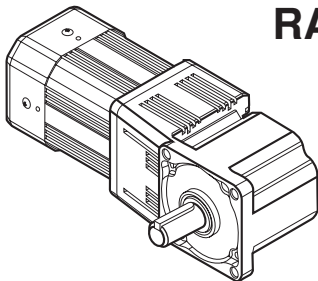

RA

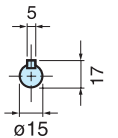
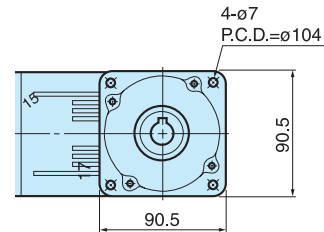
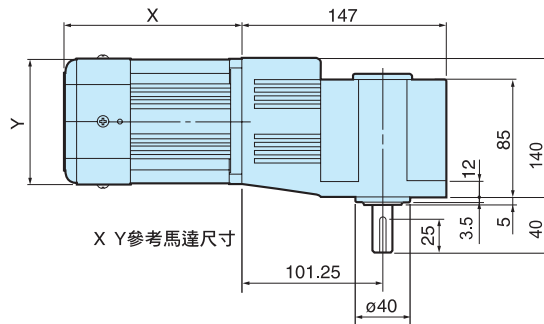

X Y 參考馬達尺寸

RH

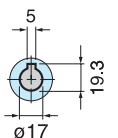
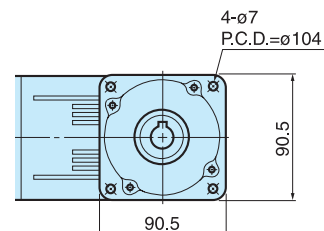
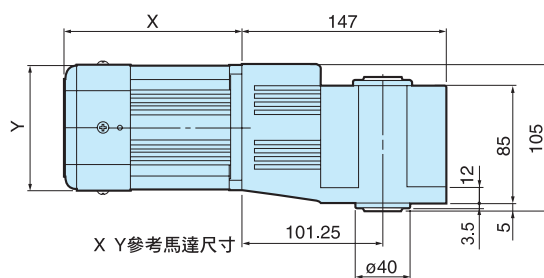
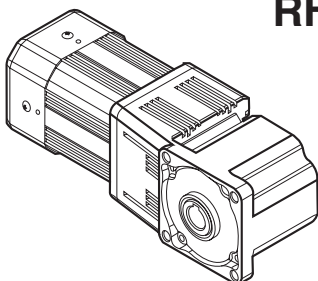

X Y 參考馬達尺寸

■ 配用馬達尺寸表
Motor Spec.

馬力	X(mm)						Y(mm)	馬力	X(mm)						Y(mm)
	IK	IK-B	RK	US	US-B	□外徑			IK	IK-B	RK	US	US-B	□外徑	
25W	85	141	85	96	151	□80	90W	155	220	155	163	220	□90		
40W	107	164	107	117	182	□90	120W	155	220	155	163	220	□90		
60W	142	193	142	142	193	□90	150W	155	220	155	-	-	□90		

以上數值若有變動，恕不另行通知 We reserve the right to change without further notice.